

## Abstechen mit Abgreifspindel

Parting off with counter spindle

Tronçonnage avec contre-broche

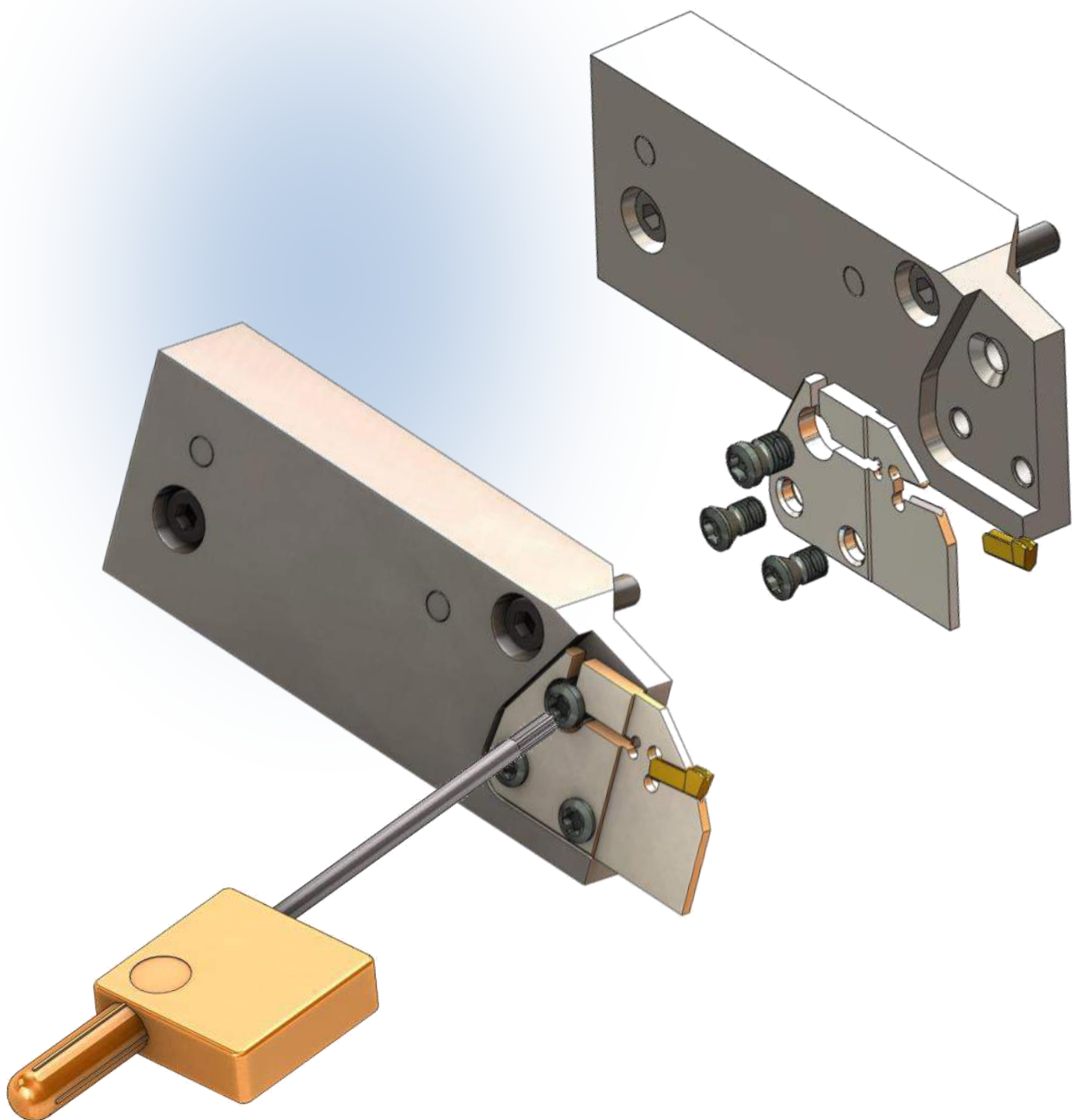

## Abstechen mit Abgreifspindel Parting off with counter spindle Tronçonnage avec contre-broche

### DIE-DECO-7-10

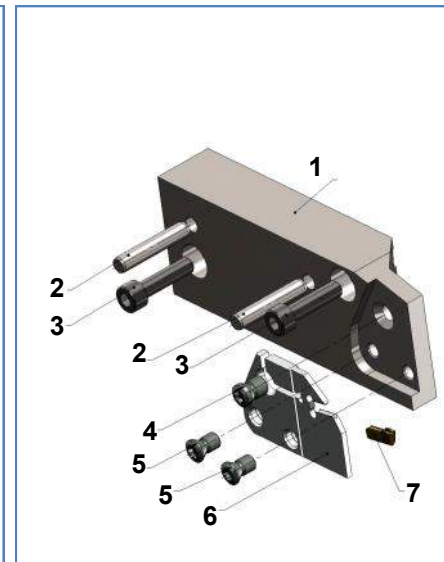
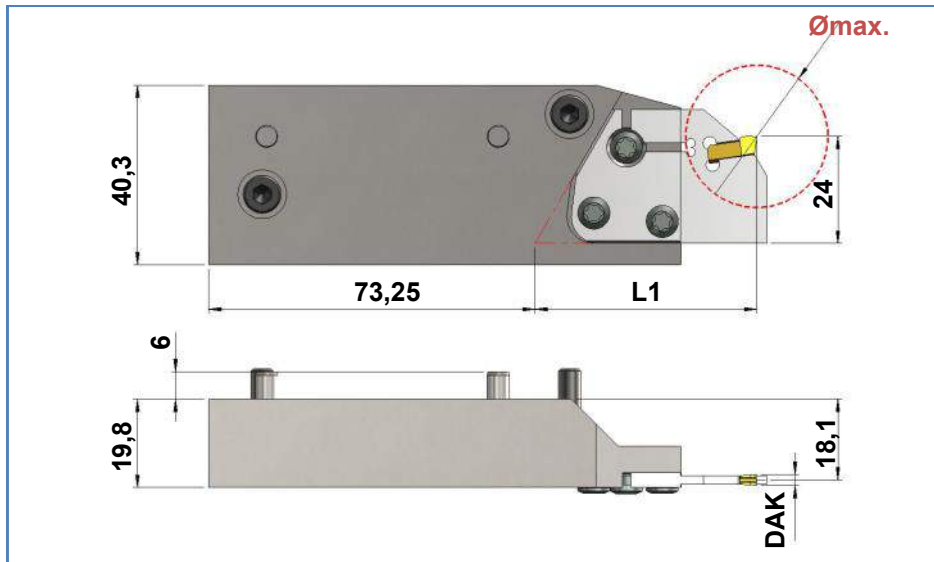

#### 1. Grundhalter

Basic tool holder  
Porte-outil de base

| Art. Nr.<br>Item no.<br>No. d'art. | Best. Nr.<br>Ref. no.<br>Réf. |
|------------------------------------|-------------------------------|
| 107469                             | DIE-DECO-7-10                 |

| Nr. no. | Art. Nr.<br>Item no.<br>No. d'art. | Best. Nr.<br>Ref. no.<br>Réf.        | Bezeichnung<br>description<br>désignation             |
|---------|------------------------------------|--------------------------------------|---|
| (2x)    | 2 108216                           | Zylinderstift-5x26 - Ø5m6x26 DIN6325 | Anschlagstift / Dowel / Goujon de butée               |
| (2x)    | 3 108219                           | M5x20-DIN 912 SW4                    | Befestigungsschraube / Fixing screw / Vis de fixation |
| (1x)    | 4 107465                           | DIE-M6x10,4-T20                      | Spannschraube / Clamping screw / Vis de serrage       |
| (2x)    | 5 107464                           | DIE-M5x10-T20                        | Spannschraube / Clamping screw / Vis de serrage       |

#### 6. Adapter DIE-DAK...

Adapter DIE-DAK...  
Adaptateur DIE-DAK...

| Art. Nr.<br>Item no.<br>No. d'art. | Best. Nr.<br>Ref. no.<br>Réf. | DAK | Ømax. | L1   |
|------------------------------------|-------------------------------|-----|-------|------|
| 120619                             | DIE-DAK-16-16-NV              | 1.6 | 16    | 45   |
| 120620                             | DIE-DAK-16-20-NV              | 1.6 | 20    | 49,3 |
| 120623                             | DIE-DAK-16-20-SL-NV           | 1.6 | 20    | 51,5 |
| 122026                             | DIE-DAK-16-28-NV              | 1.6 | 28    | 49,8 |
| 120621                             | DIE-DAK-24-20-NV              | 2.4 | 20    | 49,3 |
| 120622                             | DIE-DAK-24-32-NV              | 2.4 | 32    | 49,8 |
| 121484                             | DIE-DAK-32-32-NV              | 3.2 | 32    | 49,8 |

#### 7. HM-Wechselplatten

Carbide interchangeable inserts  
Plaquettes interchangeables

DAK-1.6...

DAK-1.6...

DAK-1.6...

DAK-1.6...

DAK-2.4...

DAK-2.4...

DAK-3.2...