

Abstechen / Parting off / Tronçonnage

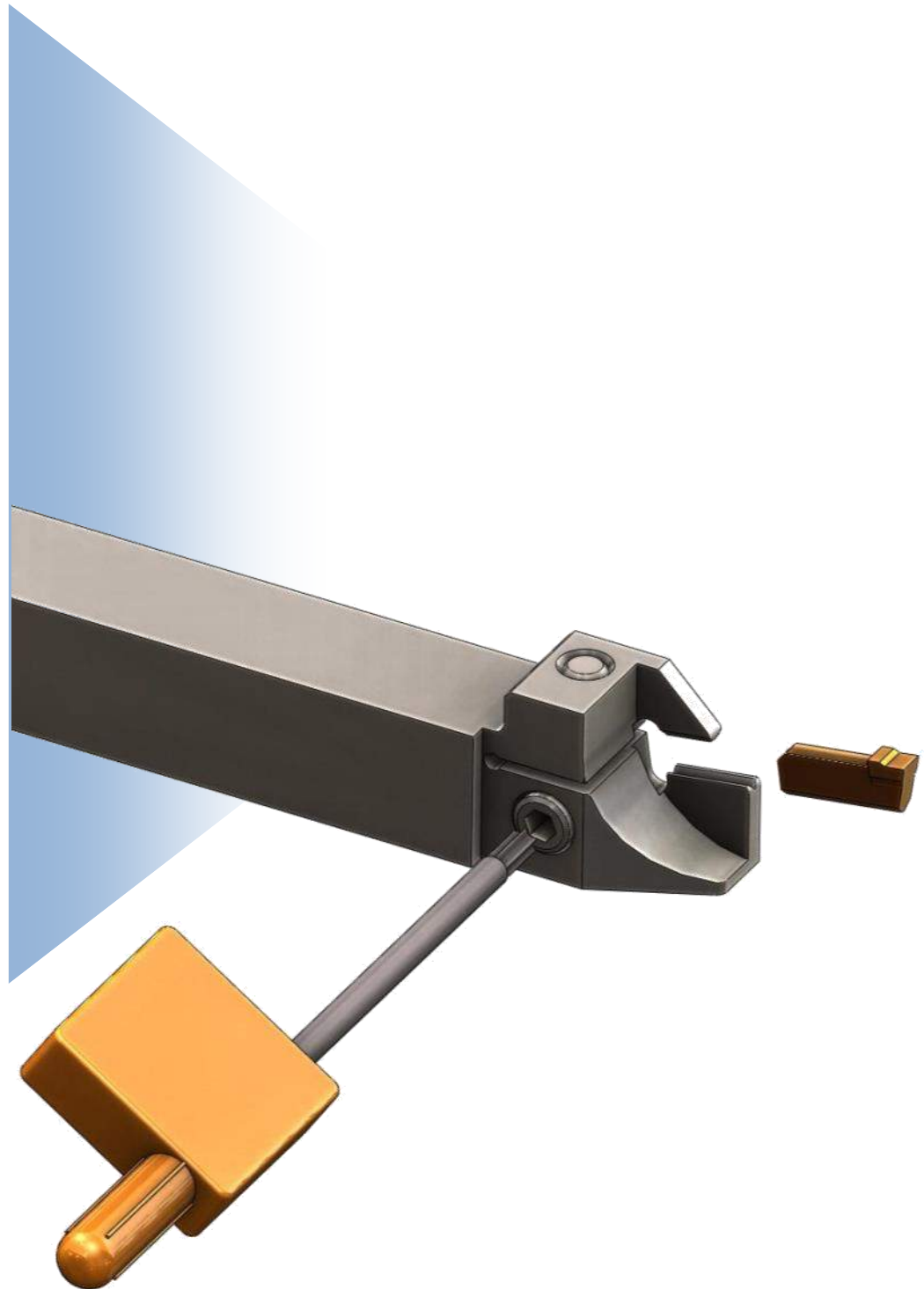

Abstechen / Parting off / Tronçonnage

SSDA-BS-16-10-1212-R

Art. Nr. 127977

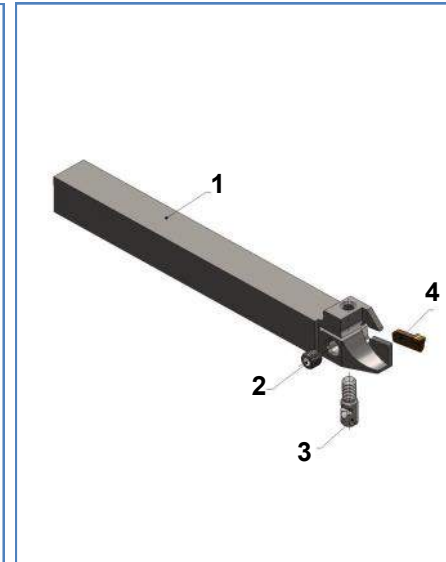
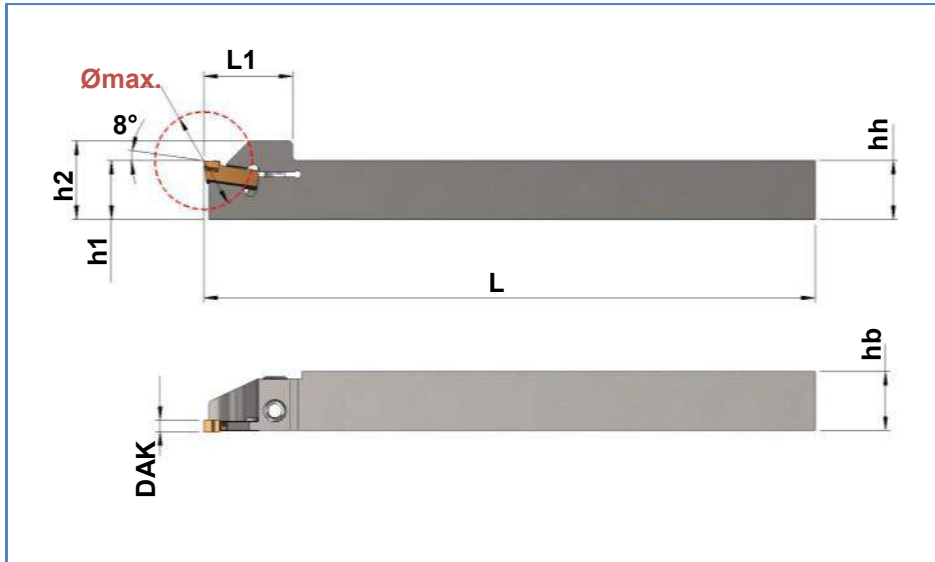
1. Grundhalter

 Basic tool holder
 Porte-outil de base

Art. Nr. Item no. No. d'art.	Best. Nr. Ref. no. Réf.	DAK	Ømax.	hb	hh	h1 +0,05	h2	L	L1
127977	SSDA-BS-16-10-1212-R	1,6	20	12	12	12	16	125	18

Nr. no.	Art. Nr. Item no. No. d'art.	Best. Nr. Ref. no. Réf.	Bezeichnung description désignation
(1x)	2 147732	M5x6-DIN 914 SW2.5	Gewindestift / Threaded pin / Tige filetée
(1x)	3 147734	SZ-5-12-15	Spannzylinder / Clamping cylinder / Cylindre de serrage
(1x)	4 -	DAK-16-...	HM-Wechselplatten/ Carbide interchangeable inserts / Plaquettes interchangeables

Abstechen / Parting off / Tronçonnage

SSDA-BS-24-10-1212-R

Art. Nr. 137933

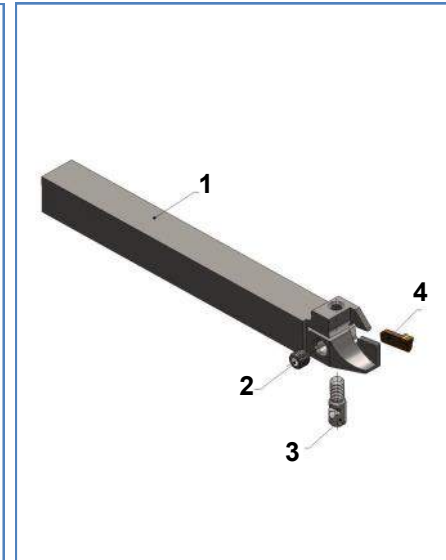
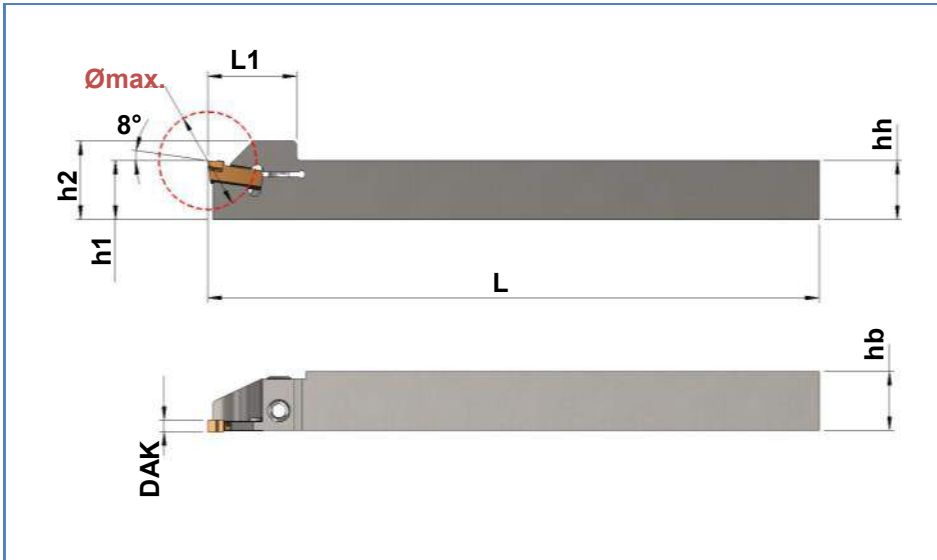
1. Grundhalter

 Basic tool holder
 Porte-outil de base

Art. Nr. Item no. No. d'art.	Best. Nr. Ref. no. Réf.	DAK	Ømax.	hb	hh	h1 +0,05	h2	L	L1
137933	SSDA-BS-24-10-1212-R	2,4	20	12	12	12	16	125	18

Nr. no.	Art. Nr. Item no. No. d'art.	Best. Nr. Ref. no. Réf.	Bezeichnung description désignation
(1x)	2	147732	M5x6-DIN 914 SW2.5 Gewindestift / Threaded pin / Tige filetée
(1x)	3	147734	SZ-5-12-15 Spannzylinder / Clamping cylinder / Cylindre de serrage
(1x)	4	-	DAK-24-... HM-Wechselplatten/ Carbide interchangeable inserts / Plaquettes interchangeables

 Otto Dieterle Spezialwerkzeuge GmbH,
 Predigerstr. 56, 78628 Rottweil, Germany Tel.: +49(0) 741 94205-0 Fax: +49(0) 741 94205-50 info@dieterle-tools.com
 www.dieterle-tools.com